

# SPEIRS MAJOR

Avenue of Stars,  
Hong Kong

# LIGHT ARCHITECTURE

8 Shepherdess Walk  
London,  
N1 7LB  
United Kingdom

T +44 (0)20 7067 4700

Co-lab Shibuya Cast  
23-21, Shibuya 1-Chome  
Tokyo 150-0002  
Japan

T +81 (0)3 3400 8855

[info@smlightarchitecture.com](mailto:info@smlightarchitecture.com)  
[press@smlightarchitecture.com](mailto:press@smlightarchitecture.com)

# SPEIRS MAJOR



The link and connecting piece for the newly sculpted landscape along the edge of Kowloon. The design of the light to the Avenue of Stars provides a visually positive landmark whilst creating a safe, calming environment by night.

CLIENT  
New World  
Development

DATE  
2012-2019

LANDSCAPE ARCHITECT  
Field Operations

EXEC. LANDSCAPE  
CONSULTANT  
Urbis Limited

EXEC. ARCHITECT  
Ronald Lu & Partners

ELECTRICAL  
ENGINEERING  
Parsons Brinkerhoff;  
WSP

STRUCTURAL  
ENGINEERING  
Arup

PHOTOGRAPHER  
Jackie Chan

PROJECT TEAM  
Keith Bradshaw,  
Carrie Donahue  
Bremner, Adrien



# SPEIRS MAJOR





**SPEIRS MAJOR**





# SPEIRS MAJOR

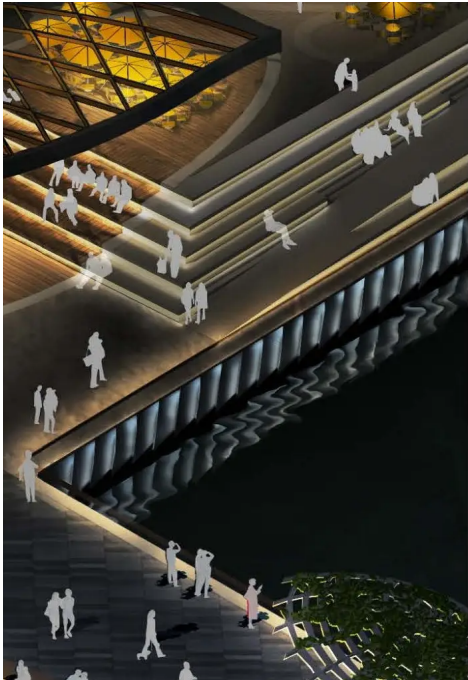

# SPEIRS MAJOR

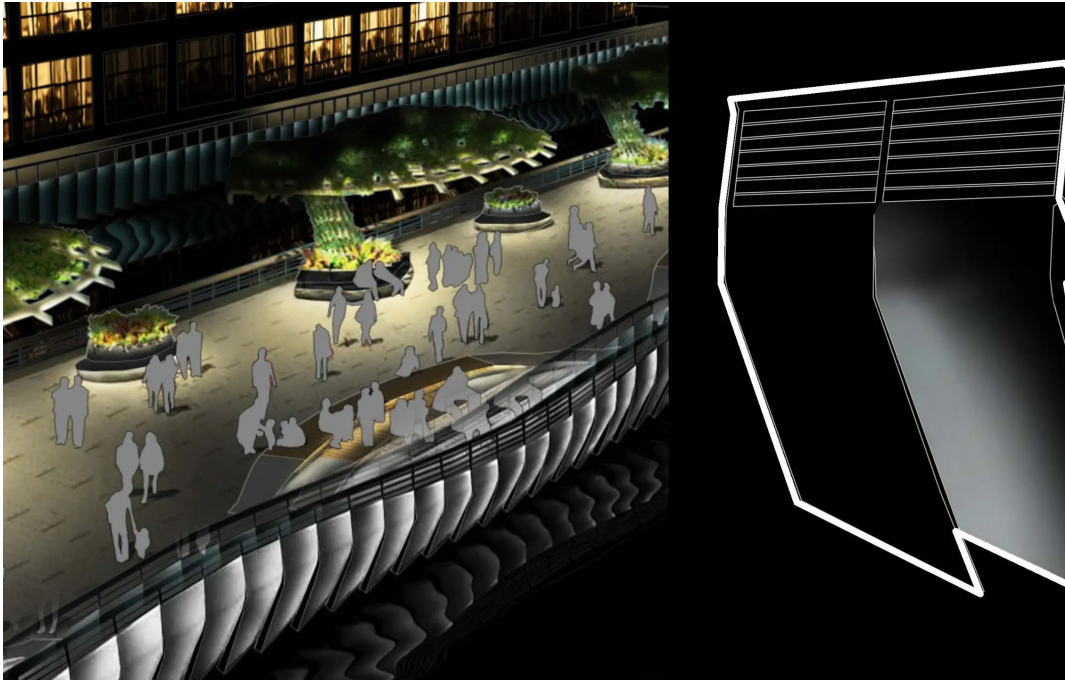



# SPEIRS MAJOR

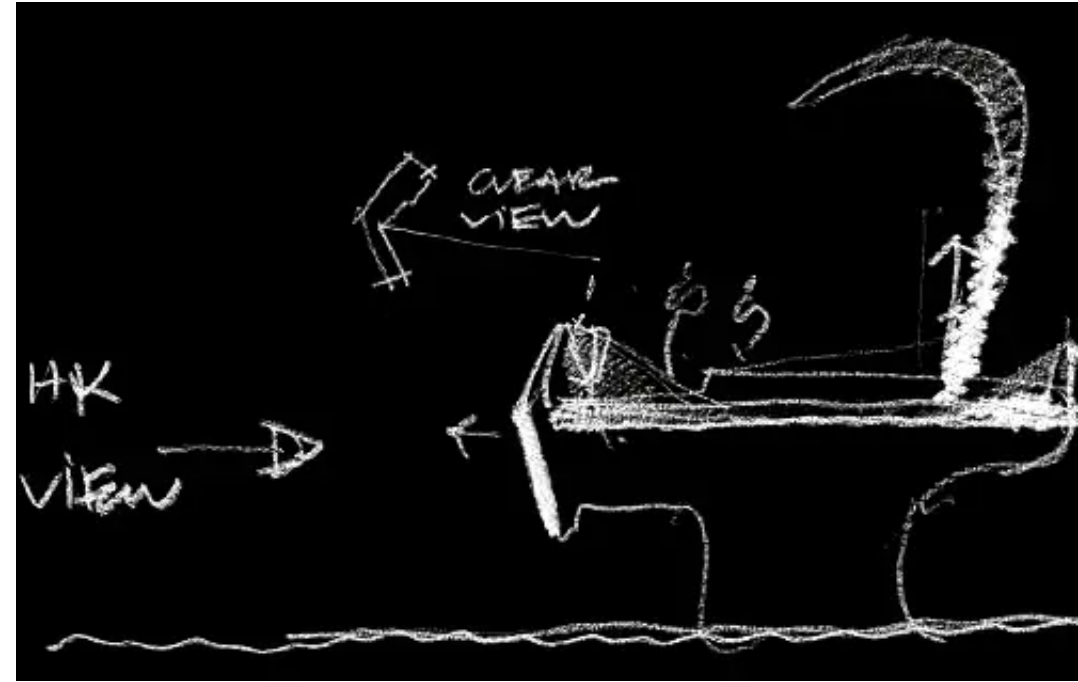
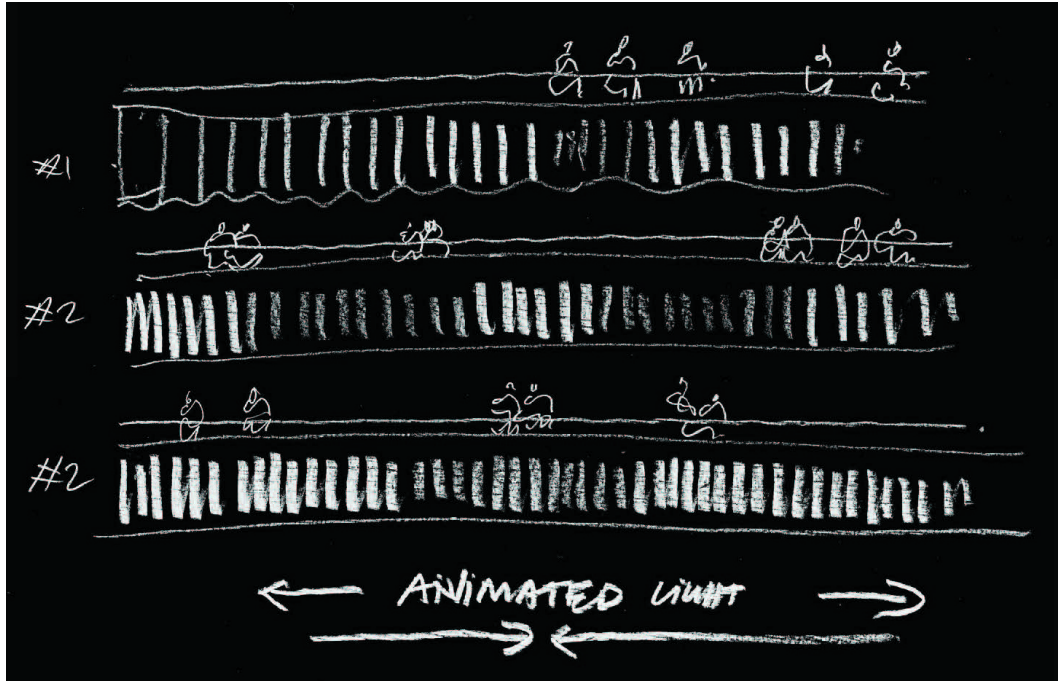

All light sources are LEDs mounted within weatherproof, marine resistant enclosures. Balanced light scenes can be adjusted using a fully automated lighting management system.